

# ELECTRIC SWEAT

## Hospitality | Catering | Technical Rider

Dear Promoter!

Dear Technical Staff!

Please read this rider carefully. Please report any objections, questions or difficulties as soon as possible to settle things in time.

Thank you very much in advance for your cooperation, we are looking forward to delivering the best show possible for your audience!

### CONTACT

Wilhelm Engl | +43 676 774 25 76

[info@electric-sweat.com](mailto:info@electric-sweat.com)

Approval to this Rider by Promoter

---

Date & Signature

THIS RIDER IS PART OF THE CONTRACT. IT HAS TO BE SIGNED AND RETURNED AT LEAST 2 WEEKS BEFORE SHOW.

### GENERAL PROVISIONS

Band & Crew

3 musicians: Willy (vocals/guitar), Joe (bass), Felix (drums) 1 bus driver/merchandiser

ELECTRIC SWEAT

**2 of 5**

**Parking**

We need a safe and legal parking spot for our van

**Hotel/Hostel**

We need one or two rooms with enough beds for everyone.

All rooms must have access to shower and toilet.

Breakfast should be included.

**Merchandising**

We need a table at least 1m x 1,5m near the entrance or by the stage with a wall behind it to hang up our t-shirts and with 1 middle-european power-outlet delivering 230 Volts INCLUDING any power/plugconverter that might be necessary for your country

**Backstage**

We will need a preferably lockable room with enough space for all of us.

Please provide mirror & enough towels & a toilet.

No one will be allowed in the dressing area either prior, during or after performance without artist approval!

**Upon Arrival/ Load-In**

- A platter of cold cuts (cheese, ham, salami, etc.) and some bananas
- Coffee & tea, milk and sugar,
- Enough bottled water
- Enough beer for the evening (don't make us buy at the bar!)

**Dinner**

We need a good warm meal for everyone, no Junk food!

ELECTRIC SWEAT

### **3 of 5**

Please serve dinner after the soundcheck and at least 2,5 hours before stage time.

#### **Buyout Option**

If dinner is not provided we need a buyout of EUR 15,00 per person, and please provide a list of restaurants in walking distance to the venue. If there are no restaurants in walking distance, make sure you have a list of restaurants where we could order something.

#### **On Stage**

- 3 bottles of non-carbonated water and 3 towel

#### **Stagehands / Staff**

We need at least one sober and experienced stagehand for load in, setup and load out. We need a competent sound-engineer and light-engineer familiar with the equipment and inhouse electricity from get-in until the end of the show. The band will require 15-30 minutes of soundcheck. We play at least 100dba on stage!

#### **PA**

We need a at least 3 way PA-system with powerful subs. The PA should be adequate to the size and capacity of the venue. Capable of sustained 110db(A) at the Front Of House mix position and providing even dispersion around the whole audience area. The system needs to be hum, buzz and crackle free.

2 multiple 230V SCHUKO power outlets on stage for music equipment. See STAGE PLOT for position.

MIDDLE-EUROPEAN-STANDARD IF NECESSARY FOR YOUR COUNTRY.

#### **General**

In addition to the existing lights we provide lights for our individual lightshow.

Again, thank you very much for your cooperation & looking forward to the show!

**electric-sweat.com**

Stage Plot

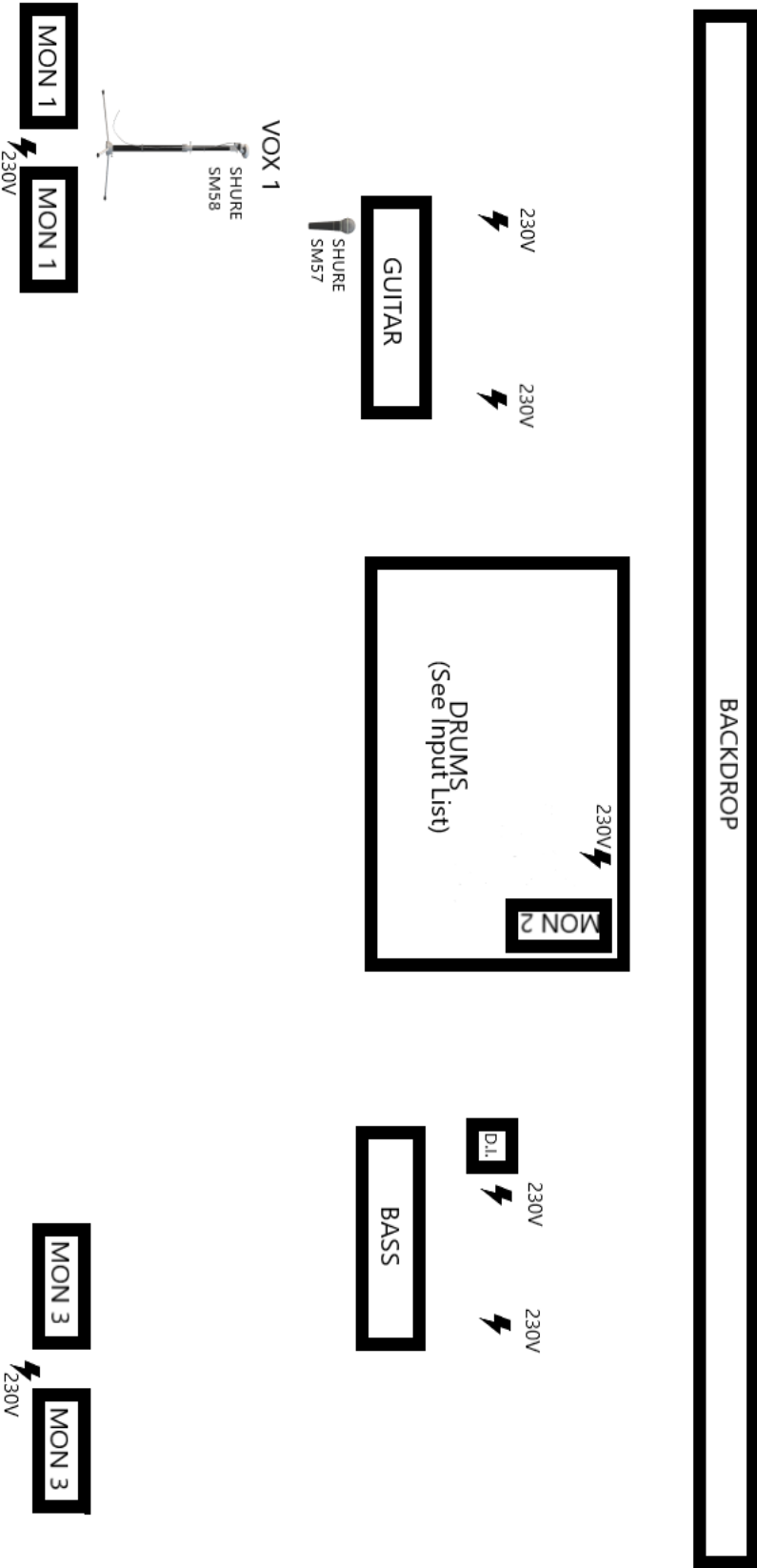

## Input List

Input	Instr	Mic/DI	P48	Stand
1	Kick in	Beta 91 (own)		
2	Kick out	D6 (own)		clip
3	Snare top	I5 (own)		clip
4	Snare bot	e904 (own)		clip
5	Hihat	tg53 (own)		clip
6	Rack Tom	e904 (own)		clip
7	Floor Tom	D6 (own)		clip
8	Cowbell	SM57 (own)		clip
9	OH SR	ME64 (own)		clip
10	OH SL	ME64 (own)		clip
11	Bass Sans Amp	XLR		
12	Bass Mic	SM57 (own)		small
13	Guitar 57	Beta 57 (own)		small
14	Guitar 906	e906 (own)		small
15	Git Amp	SM57 (own)		small
16	Vocals SR	SM58 (own)		tall
17	FX 1L Ret			
19	FX 1R Ret			
20	FX 2L Ret			
21	FX 2R Ret			
22	FX 3L Ret			
23	FX 3R Ret			